

26 075 000 EUPHORIA SYSTEM SHOWER SYSTEM WITH THERMOSTATIC MIXER FOR WALL MOUNTING

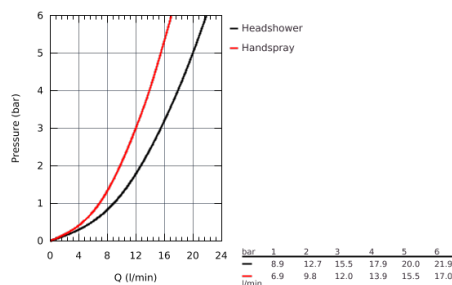

PRODUCT DESCRIPTION

- consists of:
 - Horizontal swivable 450 mm shower arm
 - exposed thermostat with Aquadimmer function
 - allows change between:
 - Rainshower Cosmopolitan 310 metal head shower (27 477)
 - spray pattern: Rain
 - with ball joint
 - angle of rotation $\pm 15^\circ$
 - hand shower Euphoria 110 Massage (27 221 000)
 - adjustable in height with gliding element
 - shower hose Silverflex 1750 mm (28 388 000)
 - **GROHE TurboStat** compact cartridge with wax thermoelement
 - GROHE SafeStop at 38°C
 - **GROHE SafeStop Plus** optional temperature limiter at 43°C included
 - **GROHE DreamSpray** perfect spray pattern
 - **GROHE StarLight** chrome finish
 - **Inner WaterGuide** for a longer life
 - **SpeedClean** anti-lime system
 - **Twistfree** (to prevent hose from twisting)
 - **GROHE MetalGrip** ergonomically shaped metal handles
 - suitable for instantaneous heaters (min. 19 kW/h)
 - minimum flow rate 7 l/min.
 - optional upgrade: **GROHE EasyReach** tray (26 362), sold separately

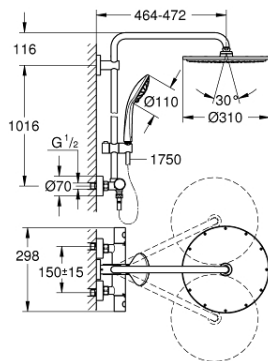

26 075 000 EUPHORIA SYSTEM SHOWER SYSTEM WITH THERMOSTATIC MIXER FOR WALL MOUNTING

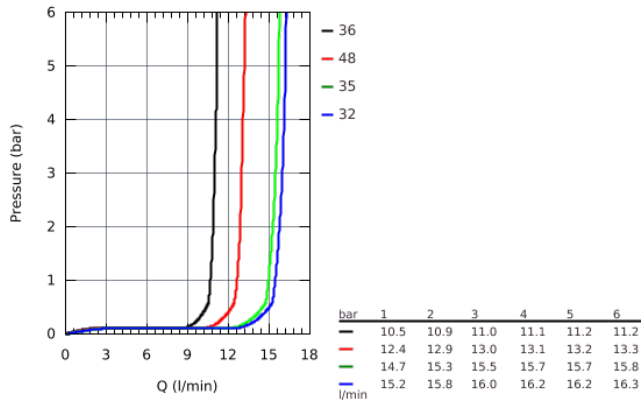

26 075 000 EUPHORIA SYSTEM SHOWER SYSTEM WITH THERMOSTATIC MIXER FOR WALL MOUNTING

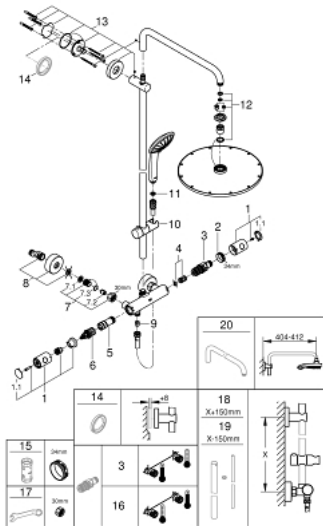

SPARE PARTS

- 1: Costa metal handle 1/2" (Order-nr. 47984000)
 - 1.1: Cap (Order-nr. 6458500M)
 - 2: Fitting ring (Order-nr. 47743000)
 - 3: Thermostatic compact cartridge 1/2" (Order-nr. 47439000)
 - 4: Sound absorber (Order-nr. 47398000)
 - 5: Water flow (Order-nr. 47751000)
 - 6: Aquadimmer (Order-nr. 12433000)
 - 7: Non-return valve (Order-nr. 47189000)
 - 7.1: Dirt Strainer (Order-nr. 0726400M)
 - 7.2: Non-return valve (Order-nr. 08565000)
 - 7.3: O-ring $\varnothing 17 \times \varnothing 2$ (Order-nr. 0305500M)
 - 8: S-union (Order-nr. 12662000)
 - 9: Non-return valve (Order-nr. 08565000)
 - 10: Sliding piece (Order-nr. 12140000)
 - 11: Dirt strainer (Order-nr. 0700200M)
 - 12: Inlet valve assembly (Order-nr. 45933000)
 - 13: Outlet shower holder (Order-nr. 48279000)
 - 14: Compensation disc (Order-nr. 27180000)*
 - 15: Socket spanner (Order-nr. 19332000)*
 - 16: Thermostatic compact cartridge 1/2" for changed waterways (Order-nr. 47175000)*
 - 17: Special spanner (Order-nr. 19377000)*
 - 18: Shower system pipe for retrofitting (Order-nr. 48053000)*
 - 19: Shower system pipe for retrofitting (Order-nr. 48054000)*
 - 20: Shower arm for shower systems (Order-nr. 14047000)*
- * Optional accessories